

INSTRUCTION MANUAL

Wi-Fi Curtain Module

QS-WIFI-C01

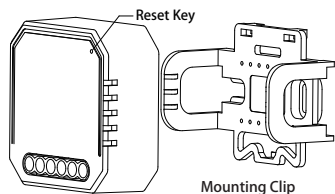

RoHS



TECHNICAL SPECIFICATIONS

Product type	Wi-Fi Curtain Module
Voltage	220-240V AC 50/60Hz
Current	3A
WiFi frequency	2.4GHz - 2.4835GHz WIFI
Operation temp.	-10℃ - +40℃
Case temp.	Tc: +80℃ (Max.)
Operation range	<200 m
Dims (WxDxH)	46x46x18mm(without clip)
IP rating	IP20
Warranty	3 years

EMC Standard (EMC)

EN 300 328 V2.1.1 (2016-11),
EN 301489-1 V2.1.1 (2017-02),
EN 301489-17 V3.1.1 (2017-02),
EN 62311:2008, EN 61000-6-1:2007,
EN 61000-6-3:2007+A1:2011

Safety Standard (LVD)

IEC 60669-2-1:2002/AMD1:2008/
AMD2:2015, IEC 60669-1:1998/
AMD1:1999/AMD2:2006,
EN 60669-2-1:2004+A1:2009+A2:2010,
EN 60669-1:2018

RoHS Standard (RoHS)

2011/65/EU, (EU) 2015/863

Radio Equipment (RED)

ETSI EN 300 328 V2.1.1 (2016-11)

Global international operation Whenever & Wherever You are, All-in-one Mobile App

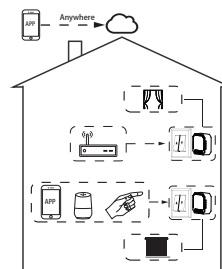

Inhouse local operation

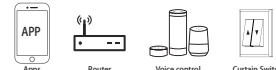

MANUAL OVERRIDE

The Curtain module terminal reserves the access of manual override function for the end-user to switch on/off

- If you have connected the wall push-button, check its work. Single pressing of the "down" button / "up" button, will cause that the roller shutters moves in the desired direction to the end position. If the electric shutter goes in the opposite direction to the expected, select "motor reversal" in the "More" option. When the electric shutter is moving up, pressing "up" button switches causes that the shutter will stop immediately; when the electric shutter is moving down, pressing "down" button switches causes that the shutter will stop immediately.

Notes:

- Both the adjustment on App and Curtain can overwrite each other, the last adjustment remains in memory.
- The App control is synchronized with the manual switch.

INSTALLATION

▲ Warnings:

- Installation must be carried out by a qualified electrician in accordance with local regulations.
- Keep the device out of reach of children.

- Keep the device away from water, damp or hot environment.
- Install the device away from strong signal sources such as microwave oven that may cause signal interruption resulted to abnormal operation of the device.
- Obstruction by concrete wall or metallic materials may reduce the effective operation range of the device and should be avoided.
- Do NOT attempt to disassemble, repair or modify the device.

with mounting clip

without mounting clip

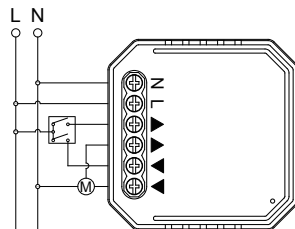
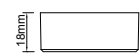
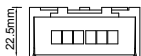
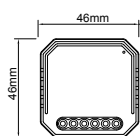
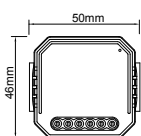

Wiring Instructions and Diagrams

- Turn off the power supply before carrying out any electrical installation work.
- Connect wires according to the wiring diagram.
- Insert the module into the junction box.
- Connect the power supply and follow Curtain module configuration instructions.

Notes: Take your smartphone close to the Curtain module when you're configuring, and make sure you have min. 50% Wi-Fi signal.

FAQ

Q1: What should I do if I can't configure the Curtain module?

- Please check whether device is powered on.
- Make sure your mobile and Curtain module are under the same 2.4 Ghz WIFI network.
- Whether it's in good internet conditions.
- Make sure the password entered in App is correct.
- Make sure the wiring is correct.

Q2: Which products can I control with the device?

Curtain, shutter, blind,....

Q3: What happens if the WIFI goes off?

You can still control the device connected the Curtain module with your traditional Curtain and once WIFI is active again the device connected to module will connect automatically to your WIFI network.

Q4: What should I do if I change the WIFI network or change the password?

You can connect the module to the WIFI network according to the App User Manual.

Q5: How do I reset the device?

Power on/off device 5 times or press the reset key for about 10 seconds until the beeper on the module sound continuously.

APP USER MANUAL



IOS APP / Android APP

1

Scan the QR code to download Tuya Smart App, or you can also search keyword "Tuya Smart" at App Store or Googleplay to download App.

2

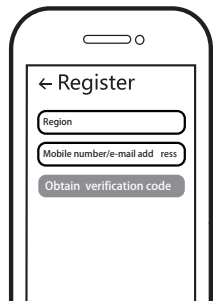

Log in or register your account with your mobile number or e-mail address. Type in the verification code sent to your mobile or mail box, then set your login password. Click "Create Family" to enter into the APP.

3

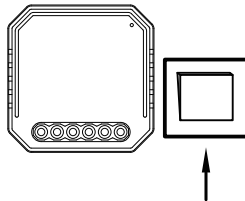

After the wiring of curtain module is done, press the traditional switch to turn ON/OFF cycle for 5 times (keep time interval not too short) or press the reset key for about 10s until the beep sound continuously for pairing mode.

4

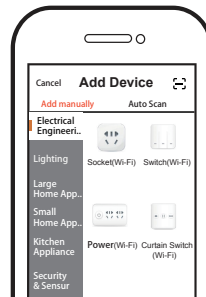

Open the APP, selecting "+" on top right to add device. Choose "Electrical", and select "Curtain Switch".

5

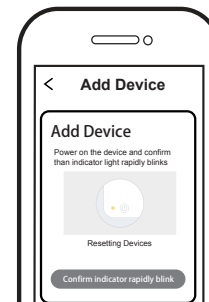

Make sure your smart phone and Wi-Fi curtain module are under the same Wi-Fi network at 2.4GHz connection. Confirm when the beep sound continuously for pairing mode.

6

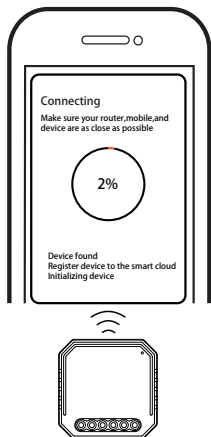

The pairing will take about 10-120 seconds to complete depending on your network condition.

7

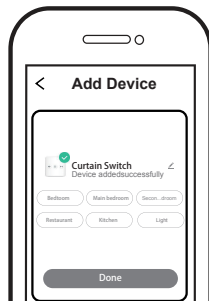

When pairing is done, the Wi-Fi curtain will be shown on the App.

8

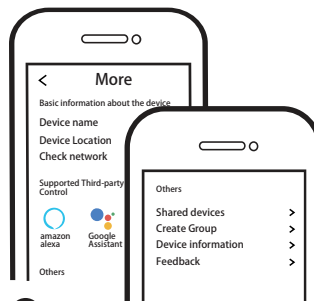

Connect to amazon alexa or Google Assistant for voice control, or share the devices with your families or friends.

9

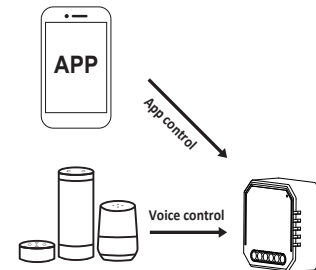

Enjoy your smart life of home automation for lighting control by using our All-in-one mobile app wherever you are in the world or simply by voice control when you are sitting at home comfortably.